

PM2R / PS2R Dual Temperature Replacement Pneumatic Valve

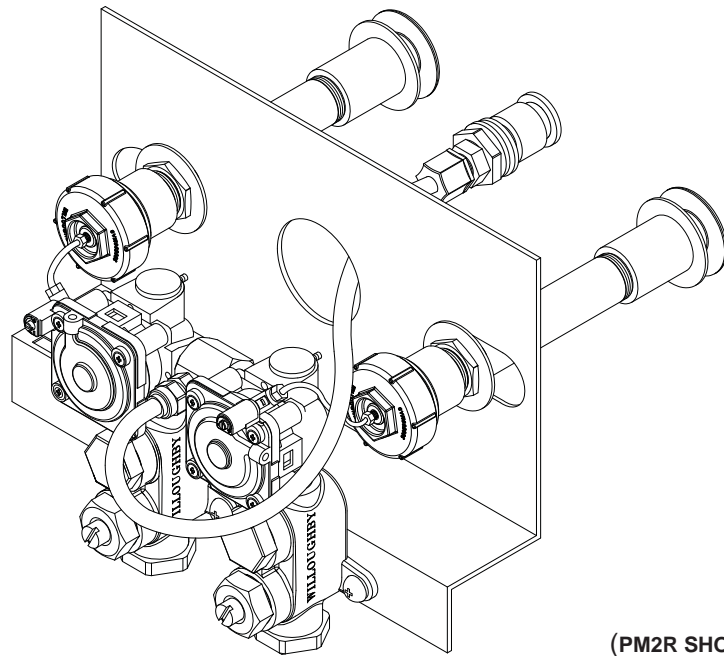

Recommended Specifications

Dual Temperature, Replacement Pneumatic Valve assembly shall be: Willoughby Model No. **P__2R** (Select from options list)

Not for use in the states of California or Vermont.

This valve is designed to replace existing valves on china and aluminum fixtures with integral bubblers. The valve assembly shall use diaphragms to pneumatically activate non-hold open metering (5-90 second) or non-metering pneumatic valves. The vandal-resistant push buttons shall be keyed/non-removable from the front of the fixture and shall require less than 5 lbs of force to operate. The push button assembly is arranged to be mounted to the back-splash to support the fixture.

The valve checkstop/strainers shall be cast brass with integral mounting lugs. Replaceable stainless steel strainers and 1.0 GPM flow control shall be serviced without disturbing the supply line. The connection to the filler/bubbler shall be flexible tubing. Water inlets are 1/2" FPT and shall be reversible for either top or bottom supply. The valve assembly is accessible from the pipe chase only.

Flexible tubing is supplied for walls up to 8" thick. Recommended operating pressure shall be 35-70 psi. Valve shall withstand pressures up to 90 psi. The maximum length for tubing between the push button actuator and the valve is 10 feet. The pneumatic system is entirely self-contained and shall require no outside air supply. Cost reducing manifolded valves shall consist of multiple valve assemblies served by a common supply line.

Model Number:

- PM2R Dual Temp. Metering
- PS2R Dual Temp. Non-metering

Wall Thickness (choose one):

- 1" (PM-2F-1.0-S-1)
- 4" (PM-2F-1.0-S-4)
- 6" (PM-2F-1.0-S-6)
- 8" (PM-2F-1.0-S-8)

Inlet Connection (choose one):

- 3/4"
- 1"

Options:

- MA2 (Double Manifold, No flow limitation)
- MA3 (Triple Manifold, 0.5 GPM flow only)
- MA4 (Quad Manifold, 0.5 GPM flow only)
- TMV In-line Thermostatic Mixing Valve

* This is not a substitute for a thermostatic mixing valve. The delivered water temperature is the result of the two combined inlet temperatures and cannot be adjusted by this valve assembly. The hot side of the valve must be supplied with tempered water.

** Push buttons require minimum \varnothing 1-5/16" round or 1-1/8" square backsplash openings.