

WRS-BF Series Rear Mounted Recessed Handicap Shower Panel w/ Hand Held Flexshower Head



Recommended Specifications

Rear Mounted, Recessed Handicap Shower Panel w/ Hand Held Flexshower Head shall be:
Willoughby Model No. **WRS-BF**
(Select from model number and options list on next page)

Shower panel shall be fabricated from 14 gauge, Type 304 stainless steel with exposed stainless surfaces polished to a #4 satin finish.

Standard equipment shall include:

- Shower valve (Select from Valve Selection options list)
- (NPS) non-adjustable penal shower head
- (FX) Hand held Flexshower head (w/ quick disconnect, vacuum breaker, and (1) hook)

Anchoring shall be by standard 8-point system: 1/2" threaded rods, nuts and washers shall be furnished for walls up to 8" thick. Unit requires chase area for installation and maintenance.

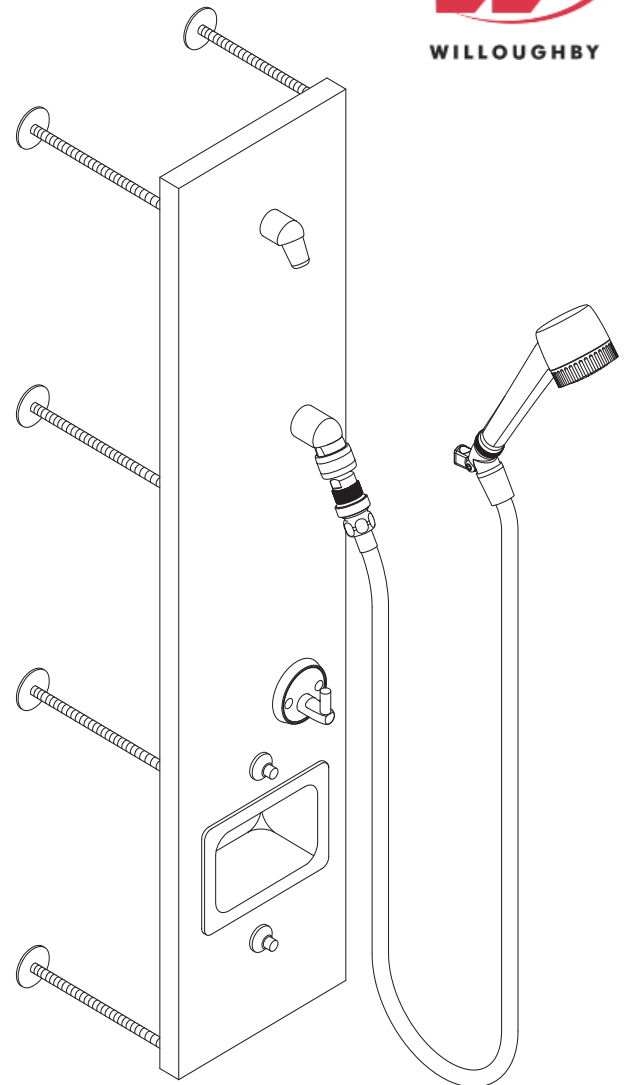

(Unit may be shown with optional features)

To specify fixture and accessories, use the Model Number and Options page.

Example: To specify a Rear Mounted, Recessed Handicap Shower Panel w/ Hand Held Flexshower Head with left hand controls, single temp. pneumatic metering valves (manifolded), standard pneumatic push buttons, standard 2.5 GPM flow rate, standard (NPS) and (FX) shower heads, in-line thermostatic mixing valve, and recessed mounted soap dish

Use the following Willoughby Model Number:

WRS-BF-L-PML1-MA2-PPB-2.5GPM-NPS-FX-TMV-RD

visit our website at www.willoughby-ind.com

5105 West 78th Street • Indianapolis, IN. 46268
(317) 875-0830 • Fax: (317) 875-0837 • (800) 428-4065



MADE IN THE U.S.A.

MODEL NUMBER AND OPTIONS:

1.) Base Model Number:

- WRS-BF Rear Mounted, Recessed Handicap Shower Panel w/ Hand Held Flexshower Head

2.) Panel Orientation (Must Specify):

- L Left Hand Controls
 R Right Hand Controls

3.) Valve Selection:

- NV No Valve
 PML1 Single Temp. Pneumatic Metering
 PML2 Dual Temp. Pneumatic Metering
 E1L1 Single Temp. Electronic (Pick Control)*
 E1L2 Dual Temp. Electronic (Pick Control)*

Valve Manifold Option:

Pneumatic or Electronic Valves Only:

(See the Manifold Option Page at the end of Catalog Section S5 for further information)

- MA2

4.) Push Button Selection:

Pneumatic or Electronic Valves Only:

- PPB Pneumatic Push Buttons
 EPB Electronic Push Buttons*
 PZPB Piezo Push Buttons*

5.) Flow Rates:

- 2.5 GPM (Standard)
 2.0 GPM
 1.5 GPM

6.) Electronic Controls* (Must Use Electronic Push Button):

- WUSC-2200 WUSC-2400 Pneumatic WMS II

7.) Shower Head Selection:

- NPS Non-adjustable Penal Shower Head (Standard)
 FX Hand Held Flexshower w/ Quick Disconnect and Vacuum Breaker (Standard)
 APS Adjustable Penal Shower Head

8.) Options:

- TMV In-line Thermostatic Mixing Valve
 TF24H Hard-wired Transformer, 110VAC to 24VAC*
 TF24P Plug-in Transformer, 110VAC to 24VAC*
 RD Recessed Mounted Soap Dish
 SD Surface Mounted Soap Dish
 WS Wall Sleeve (Requires Accessible Chase)
 Other _____
 Other _____

* (Req. 110V power through ground fault interrupter (GFCI) receptacle)

Approved For Manufacturing By: _____ Date: _____ Company: _____
 Wall Thickness: _____ Wall Type: _____



LEFT HAND CONTROL FIXTURE SHOWN
 (RIGHT HAND FIXTURE IS SYMMETRICALLY OPPOSITE)

VERIFY ALL DIMENSIONS WITH FACTORY PRIOR TO ROUGH-IN
 WILLOUGHBY RESERVES THE RIGHT TO MAKE CHANGES IN DESIGN AND DIMENSIONS WITHOUT FORMAL NOTICE AND WITHOUT INCURRING OBLIGATION.

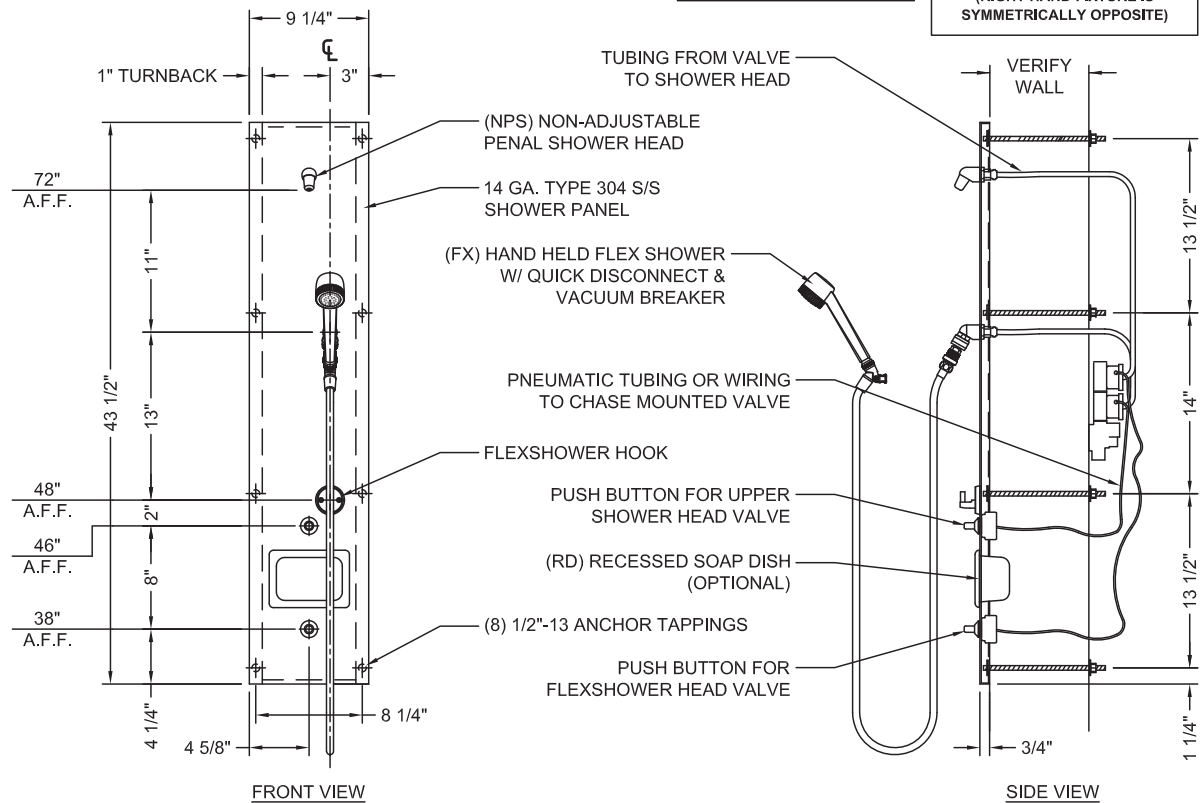

visit our website at www.willoughby-ind.com
 5105 West 78th Street • Indianapolis, IN. 46268
 (317) 875-0830 • Fax: (317) 875-0837 • (800) 428-4065



MADE IN THE U.S.A.