



BUILT TO LAST, IN AMERICA

WILLOUGHBY WWD-2

# Water Dispensing Station

The Willoughby hot and cold water dispensing station is perfect for use in institutional areas where vandalism or aggressive use is a concern.



### Hot and Cold Water

Looking for the convenience of hot and cold water on demand with the durability of stainless steel? Look no further. Our hot and cold water dispensing station is built for the toughest environments.



### Built to Last

Fabricated from heavy gauge, type 304 stainless steel and supplied with industry standard chrome plated water dispensing faucets, our water dispensing station is built to last.



### Compact Size

The unit's compact size of 16" x 20" x 11.5" makes it an excellent choice for hospitals, jails, prisons, schools, and athletic fields.

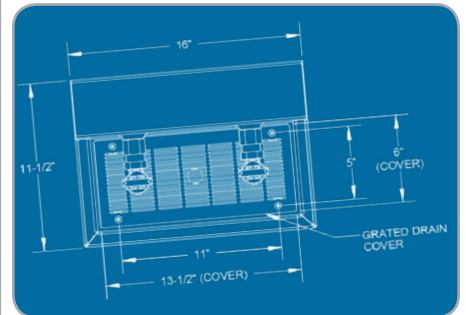

Distributed by  
**Morgan Brothers Supply**  
352-795-2999  
800-749-2999



# WILLOUGHBY

COUNT ON US.

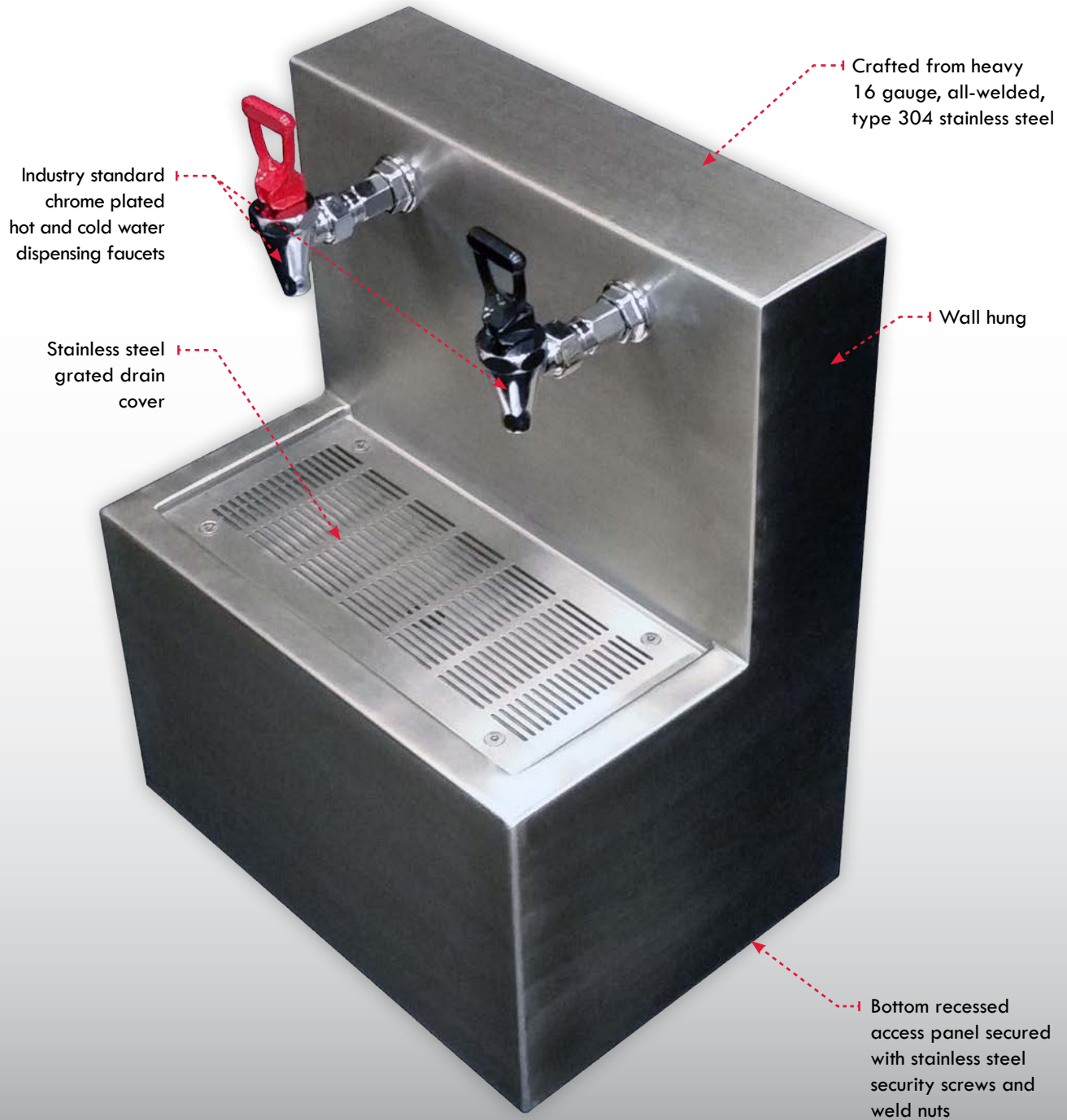

**Technical Specification:** Model WWD-2  
Standard .....16" wide x 11.5" deep x 20" tall

REVIT details available at  
[www.willoughby-ind.com](http://www.willoughby-ind.com)

Distributed by  
**Morgan Brothers Supply**  
352-795-2999  
800-749-2999

